



Using ingredients derived from soybeans, corn, coconuts, safflower, sugar cane, etc.

E-CLEAN(PUHC) E-CLEAN(HDHC)



Nondangerous chemicals

Plant-based solvent/cleaner to remove paint, ink, etc.

Features

- Removes built-up paint, ink, from hands
- Does not scratch or dull sinks like grain-filled abrasive soaps.
- Prevents slime, blockage, bad odors in waste drainage (pipes, grease traps, cisterns, etc.) when used with **E-CLEAN(HDHC)**

Merits

- no bad effects on skin like paint thinner
- improved water quality when used with **E-CLEAN(HDHC)**



Packaging 20L bulk, 200L drum

Cleaning examples

■ Dried two-component urethane paint

■ Used at 100% (5ml)

STEP 1



Work **E-CLEAN(PUHC)** into hands without water and then wipe with dry cloth.

STEP 2

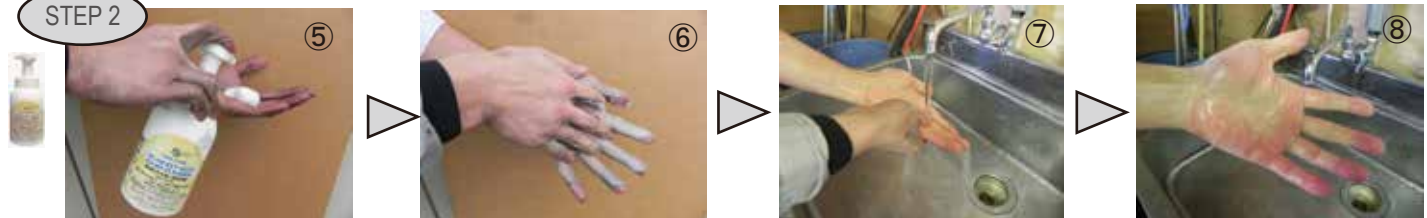

Work **E-CLEAN(HDHC)** into hands without water and then rinse with water.

Way to use

1. Apply **E-CLEAN(PUHC)** to hands (photos ①&②). Work liquid well into hands. Use brush for better effect (photo ③).
2. Without using water, wipe hands well with dry cloth (photo ④)
3. For better results, follow with **E-CLEAN(HDHC)** to remove paint buried in fingerprints and fingernails (photo ⑥).
4. Rinse well in cool or warm water (photos ⑦&⑧)
5. If any residue remains, repeat steps 1-4

■ Depending on unavoidable reasons, the specifications of the product, unit price, etc. may change without notice.

■ Images in this pamphlet may differ slightly from actual user experiences.

■ If you require SDS, please ask.

■ Please read instructions thoroughly before use.

■ Headquarters:

Takizawa Building, 3-3-6 Ebisu, Shibuya, Tokyo, Japan

■ Test Center:

2257 Nakakugi, Nishi-ku, Saitama City, Saitama, Japan

■ Factory:

2023 Hokunan Moro, Yuki, Ibaraki, Japan



Manufacturer
INFINITY Enterprises, Inc.
<http://www.safecare.jp>

Contact info for inquiries.

